

We are looking for your help!!!! Queens Platinum and Post Covid Village Event – 4th June 2022

Cllr Ferne Haxby

Plans are going ahead for the village fete and evening music entertainment event taking place on 4th June which will bring the village together for a fun filled day and evening.

As part of the plans we would like to make sure the venues look fantastic and one way is to have bunting strung around the stalls and areas of the village.

There are lots of ways that sewers and non sewers can help.

Do you have old curtains, fabric that is sitting in the corner. Brightly coloured cotton/polyester clothes that can be used to provide lots and lots of triangles which can be sewn into strings of bunting? Don't worry if you can't sew, you can cut out the triangles and we can sew these together. Of course, if you are a sewer, we can also provide the cord to put the triangles on. A template is provided in this newsletter. A new project for the New Year!!!!

If you can help us in this way, please contact the Parish Council office on info@eynsfordparishcouncil.org.uk or phone us on 01322 865320 and we can email or provide a template to use for the triangles as well as cord.

We hope that everyone will get involved to make this a day to remember. Please watch out for more exciting information around the day as we get closer to the date!!

Eynsford Parish Office

The Parish Office has a stock of black and recycling bags and garden waste sacks that you can collect/purchase during opening hours. We also offer a photocopying/printing service at competitive prices. If you have a larger amount to do, please contact us in advance to arrange. We can offer help and advice on a number of issues and can put you in touch with other services.

Normal opening hours are 8.30am—2.30pm Mon—Thurs
01322 865320; info@eynsfordparishcouncil.org.uk



Winter News 2022

from
EYNSFORD PARISH COUNCIL

Welcome to the Winter Newsletter from your parish council, packed full with useful and interesting information!

Would you like to make things happen in Eynsford? Why not apply to be a parish councillor? We currently have a vacancy and details are on page 8.

Read about improvements the parish council are making in the village at Riverside, Common Meadow and Harrow Meadow. Can you help us raise money for a new village hall and football pitch? Get in touch to find out how.

Finally, we are looking to the community to make bunting for our Jubilee/post-covid event in June. Find out how to help on page 12!

Keep up to date with your parish council on social media by following us (see below for details). Get in touch any time by email or leave a message.

Holly Ivaldi, Clerk

Eynsford Parish Council, Parish Office, Priory Lane, Eynsford DA4 0AY;
01322 865320; info@eynsfordparishcouncil.org.uk
Find 'Eynsford Parish Council' on Facebook and Twitter.
www.eynsfordparishcouncil.org.uk



Looking After Our Green Spaces

Cllr Phil Ward

We are extremely lucky to live in the Darent Valley and have unique spaces to enjoy, such as Riverside and Common Meadow. These draw visitors in from far and wide, people coming to enjoy the quaint village scenery and surrounding countryside.

Particularly during the earlier lock-downs, but throughout the covid period, we have seen an increased number of visitors to the village. This is good for local leisure businesses, but unfortunately, this increased foot-fall has taken a toll on some of our facilities, particularly the grassed area on Riverside. Part of the grass became extremely worn by the increased number of walkers heading out along the valley.

We identified this area was in urgent need of re-turfing, so have fenced off and laid new turf along this section. We delayed the works until after the peak visitor season and are pleased with the way the new turf has initially taken. We intend to keep this area fenced into the new year to give the new turf as long as possible to establish and grow. Come the spring we hope this area will look green and fresh, ready for the busy summer to come.



More visitors bring more rubbish, so we have added new bins to the area including a twin recycling bin as well as a new bin near the Roman Villa for walkers. We also trialled some CCTV cameras during the last bank holiday. Although we ultimately concluded these to be unsuitable and ineffective, we will continue to look for ways to reduce antisocial behaviour at these busy times.

Last summer, we experienced some very careless and disrespectful behaviour by a group of young visitors to Common Meadow. Suffice to say

building.

The rebuilding of the shelter on the up (London) platform is now nearing completion (this is being undertaken by Thameslink) although the project has been delayed due to the requirement for arranging on-track access.



The old shelter which is currently being refurbished.

A further £20,000 has been allocated towards a 'Station Access Feasibility Study', looking into the creation of a car park and ramp in the 'recycling' lay-by to improve disabled access to the up platform, plus funding for new signs, posters and information boards.

Eynsford Parish Council is one of the board members for DVCRP and we hope that this ongoing project will enable and enliven all that goes on in the area and will be a hub for sustainable visits to all venues and attractions on the area.

For more information visit <https://darentvalleycrp.org/>

Darent Valley Community Rail Partnership (DVCRP)

Cllr Malcolm Richardson

DVCRP was set up in September 2019 and to be a link between local communities and the rail industry. They cover the six stations between Sevenoaks and Swanley – Sevenoaks, Bat & Ball, Otford, Shoreham, Eynsford and Swanley. DVCRP aims to encourage passengers to visit local tourism attractions along the line, connect communities to their railway and boost the local economy, improve station facilities, accessibility and the natural environment. In addition they aim to link the use of the train to sustainable modes of transport (e.g walking and cycling), and raise awareness of local heritage and culture.

There are now over 70 Community Rail Partnerships (CRPs) in the UK which work with local communities and a range of partners to identify and implement measures to ensure that access to local stations is easy and that stations are safe and welcoming. Like other CRPs, DVCRP promotes sustainable, healthy and accessible travel throughout the region, while supporting diversity and inclusion in the events they co-ordinate and in the way they operate. The aim is also to help local social and economic development.

The DVCRP has recently won a national award for developing an online guide to days out by train along the Thameslink network. The 'Scenic Rail Britain' website (www.scenicrailbritain.com) offers rail travellers inspirational places to visit up and down the Thameslink lines travelling throughout the countryside, the capital, and south to the coast and north to Bedford, St Albans and Cambridge, amongst other places.

One of the aims of the DVCRP is to restore many parts of the station buildings, including the re-opening of the boarded up part of the Eynsford Station building, restoring and retaining as many heritage features as possible to provide visitors with a welcoming and informative waiting room and community space.

To date the toilets on the station have been refurbished and re-opened and Southeastern are obtaining quotes for the restoration of original features in the waiting room and booking hall, and DVCRP has some £40,000 of funds committed to the project. Discussions with the Railway Heritage Trust have indicated a further £8,000 could be provided for the restoration of the heritage features, including the boarded up windows, ceiling beams and fireplaces. A large new planter will also be provided for the front of the

we were left with no reasonable option other than to install a new section of fencing to restrict horses from the meadow and cricket pitch. This decision was made in conjunction with Eynsford Cricket Club to protect this important village facility.

The large wooden gate is no longer available but we still have vehicular access at the cricket club end. In the longer term the council intends to replace all the fencing bordering the road section of the meadow to provide a long-lasting and secure fence.



We recognise this area is enjoyed by many people including wheelchair users and those with pushchairs. To facilitate their access a new accessible kissing-gate has been installed which should deter all but the smallest of horses. The ground within the gate is clearly unsuitable at present, so we are arranging for the muddy

grass to be concreted to provide a level access through the gate.

The river aspect from Common Meadow is an intrinsic part of the village character. As such, we have produced a tree care plan for the meadow which details the care, maintenance and planting programme needed to sustain the meadow. You may also have noticed some new trees already planted to ensure succession as older trees fade.

During these unprecedented times, visitors will continue to come, enjoying the beauty of our village and hopefully spending some money locally. At the same time, we will continue to do our best to keep our treasured public spaces in a condition for all to enjoy.

NEW VILLAGE HALL at HARROW MEADOW

Update to Eynsford Community, January 2022

Cllr Alan Cooke

You should be aware by now that we have planning permission for the new hall and associated car parking along with the reconfiguration of the football pitch at Harrow Meadow. We also have planning permission for the demolition of the existing hall and the construction of three terrace houses on the existing hall site.



As part of the planning consent for the existing hall site, we are not permitted to commence demolition of the existing hall before a valid contract of work relating to the new hall is in place. This condition means we have to enter into negotiations with a contractor/developer earlier than we would normally expect to do in order to understand how much the site can be sold for and hence the actual money that has to be raised for the new hall.

At the end of September 2021 a geotechnical site investigation was carried out at Harrow Meadow. The results of this investigation was to provide outline recommendations for the foundations and the ground floor construction for the new hall as well as providing guidance for soakaway and pavement design. In addition, this investigation provided advice on the soil strata as well as identifying any potential areas of contamination for the design of the new football pitch.

For those interested, the report recommended the use of traditional strip foundations and a suspended ground floor slab and the need for shallow soakaways. The report also noted that there were no sources of contamination and the concentrations of toxic metals were low and would not pose a problem to health, no asbestos was encountered and no gas protection measures need to be incorporated in the construction of the new hall.

Following receipt of the site investigation report, the Trustees and the Parish Council have instructed the Agrostis to finalise his tender documentation and to invite at least four contractors to tender the ground works to reconfigure the football pitch.

It is a planning condition from Sevenoaks that the village hall project must start on or before three years from the date when planning permission

framework which governs what it can and cannot do.

Eynsford Parish Council owns allotments, three recreation areas and three buildings which it looks after. The council works closely with village groups and with other local councils to make improvements and to influence developments.

Currently the parish council is working closely with the village hall trustees over the new village hall project, its working on a Highways Improvement Plan to submit to Kent Highways and has set up a Greener Eynsford working group to look at how the council can play its part in reducing carbon emissions. The council is also part of the Darent Valley Landscape Partnership and the Darent Valley Community Rail Partnership.

The council is also open to new ideas for improvements and projects that will benefit the village and its residents.

If co-opted you will be asked to complete a Register of Interests and sign the Code of Conduct as you will be holding a public office. You may be asked to attend training courses from time to time.

The position is voluntary, but reasonable expenses will be paid for attending meetings/events out of the local area.

We are a friendly bunch and aim to improve things for our community. We welcome applications from all ages and backgrounds.

If you are interested, please write a brief statement about yourself and what skills or knowledge you can offer. It would also be useful to hear about any particular areas of interest that you have that are relevant to the role. Please send this to the Clerk by 13th February 2022.

Any qualifying candidates will be put forward for co-option and one will be elected by members of the council to serve until the end of the current term, which is 2023. You may then stand for re-election, and you may also resign your position at any time.

You may be asked to meet with councillors prior to the co-option vote.

If you have any further questions, please contact Holly Ivaldi, Clerk 01322 865320 info@eynsfordparishcouncil.org.uk or speak to another member of the council.

You Could Make a Difference! Causal Vacancy

Holly Ivaldi, Clerk

Following the resignation of Cllr Kirby, we have a vacancy for a parish councillor. We are looking for someone who is interested in contributing to the village and community and has a few spare hours per month. You would be representing the community in making things better for Eynsford.

There are 8 councillors on the council and they are supported by two part-time Clerks. Councillors make decisions about how the council's precept is spent, this is paid for by Eynsford residents' Council Tax. The council is able to feed into policy and legislation at local, county and government level through various consultations. The council is consulted on all planning applications in the parish. There is also more local business including dealing with village amenities, maintaining recreation areas, and responding to issues as they occur.

The council has five committees: Planning, Highways & Transportation, Community, Open Spaces and Facilities & Environment. There are also sub-committees including: Tree Work, The Green Team, Finance and Street Lighting.

This is what is required of you:

- Attending two meetings per month – these are usually held on the first Monday and third Thursday of the month at 7.30pm
- Reading and responding to relevant emails
- Attending a public 'surgery' from 9am-11am, when possible, on the last Saturday of the month
- Occasionally attending other meetings
- Occasionally representing the council at other events.

You need to:

- Be resident or work in Eynsford (or within 3 miles) for at least 12 months and be over 18*
- Be without a recent criminal conviction*
- Be on the register of electors*
- Be interested in what happens in the village and be keen to make a difference!

(*full details of relevant legislation available on request)

The Council has various statutory duties including setting a precept and budget, holding an annual meeting, and suchlike. It works within a legal

was granted which was July 2020. Therefore, it is proposed subject to the tendered figure being acceptable, to commence the ground works for the football pitch in June 2022, just after the parish council's event on Harrow Meadow.

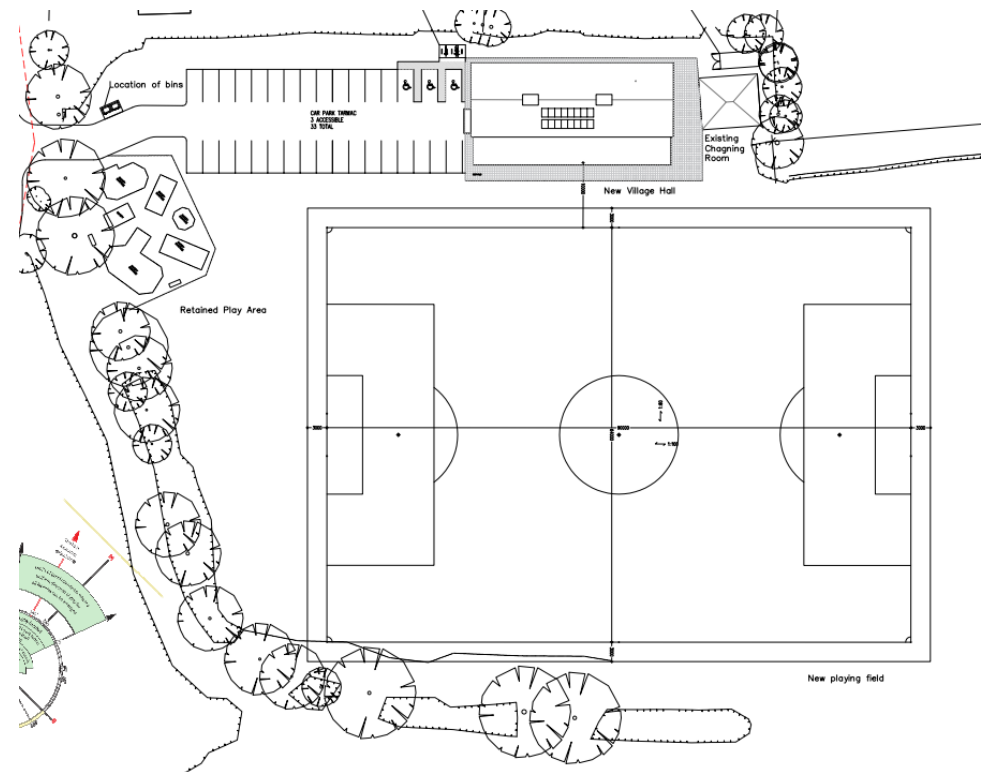

During these ground works residents are asked to take particular care when accessing the play area. Harrow Meadow will be out of use for between 12 to 18 months, and the farmland area immediately behind the allotments will be closed to walkers as earth moving machinery will be in operation.

The development committee have agreed to progress the building work for the new hall on the basis of a two stage design and build tender. Consultants will be asked to provide the Trustees with their likely fee to produce the necessary information so that the quantity surveyor can send the Stage 1 tender out to interested contractors. These tenders combined with the work to the football pitch will provide a better indication as to the overall cost of the project.

As of January 2022 we commence in earnest to start fund raising. A committee chaired jointly by Holly Ivaldi and Bidget Storrar have arranged a meeting on 10th January in the village hall at 7.30 to bring together a number of volunteers as well as members of various user groups who wish to help in raising the funds to build an exciting new hall in Eynsford.

If you feel you could help in this task even in just a small way please get in touch with Holly at the parish office. Fund raising may include events in the village hall, garden safari, outdoor sports, support of the current hall lottery or sponsorship of an element of the new building. To kick start this we will be setting up an online donation site and we would very much appreciate your donations big or small to help build our new hall for the future. Updates will be posted on the Eynsford Village Hall facebook page and on eynsfordvh.com

Tree Planting at Common Meadow

Cllr Michael Barker

The first phase of tree work has now been completed at the common meadow. The main features of this tree work are, reduction of the crown of two out of the five mature willow trees and planting of three new willow trees one London plane tree and one yew tree.

The reason for the work on the willow trees is that while willows are beautiful trees and thrive on the riverbank they do not have a long life span, probably 50-60 years. The life span can be prolonged somewhat by reducing the limbs to reduce the weight. The foliage will grow back to its former glory in 2-3 years so the visitors to the common meadow will be able to enjoy the sight of these iconic tree quite soon. In order to reduce the immediate visual impact of the work, the other three trees will be reduced next year, by which time the first two will show signs of recovery.

The reason these two trees were chosen was because one of them had a



limb that was in danger of falling down onto the riverbank, possibly causing damage to life and limb of passers-by.

Even after this work has been done it is likely that these mature willows will have to come down within the next 20 years, which is why three new willow



trees have been planted. These trees will be approaching full size in 20 years time. It may be necessary to plant further willow trees in the future to maintain this wonderful display for future generations.

Also planted further along the river bank, downstream, is a London plane tree, which will be a magnificent tree similar to the one next to the bridge in the grounds of the Riverside Club, a tree which, in many years time, will enhance the common meadow immeasurably.

A pretty yew tree has been planted adjacent to the cricket pavilion to replace a dead tree that was originally planted to commemorate the life and contribution to the cricket club of Peter Brown. We hope and expect that, with appropriate care, the new tree will be a striking and long-lived memorial to "Brownie".

In addition to this, some trees, including alders, growing alongside the hedge between the common meadow and the Riverside Club, have been coppiced in order to promote vigorous new growth and eliminate disease.